

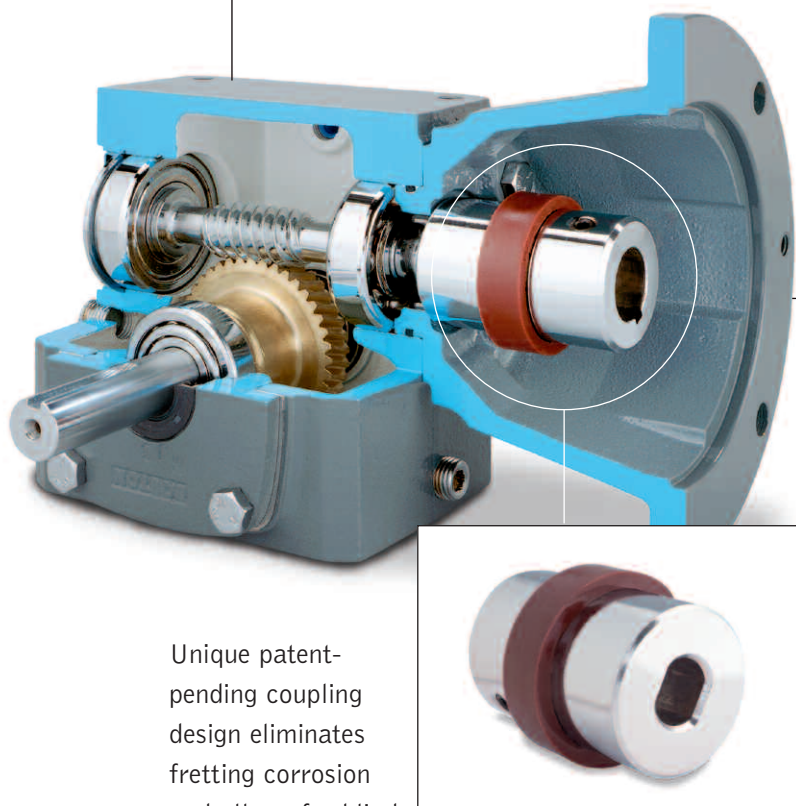

Boston Gear QC 700 Series

NEMA Flanged Reducer Coupling Style



Unique patent-pending coupling design eliminates fretting corrosion and allows for blind assembly of NEMA motors.

Reducer Express

We guarantee same day shipment by air if we receive your order by 12pm EST or we guarantee next business day shipment by air if your order is received after 12pm EST... or the air freight is free!



The Fastest Motor-Reducer Assembly in the West (and the East)

Many maintenance engineers and industrial OEM's choose couplings to connect their motors and gearboxes together. The advantages can be many, but the disadvantages can quickly add up. That's because a slot must be cut in the gearbox flange to allow an Allen wrench to align the coupling... the same slot that lets in caustic washdown solution, water, and other particles, also makes it challenging to see what you need when connecting the motor.

That's why Boston Gear developed the QC 700 Series, featuring a completely self-aligning coupling that eliminates the need for a slot in the flange and allows for quick motor and reducer assembly. Fretting corrosion is eliminated, which means your motor comes off when you want it to – with hand tools, not a jackhammer. The QC 700 Series is truly the first quick connecting NEMA coupling-mount speed reducer in its class.

For Technical Assistance Call

800-825-9050

 **Boston**
Gear

An Altra Industrial Motion Company

QC 700 Series

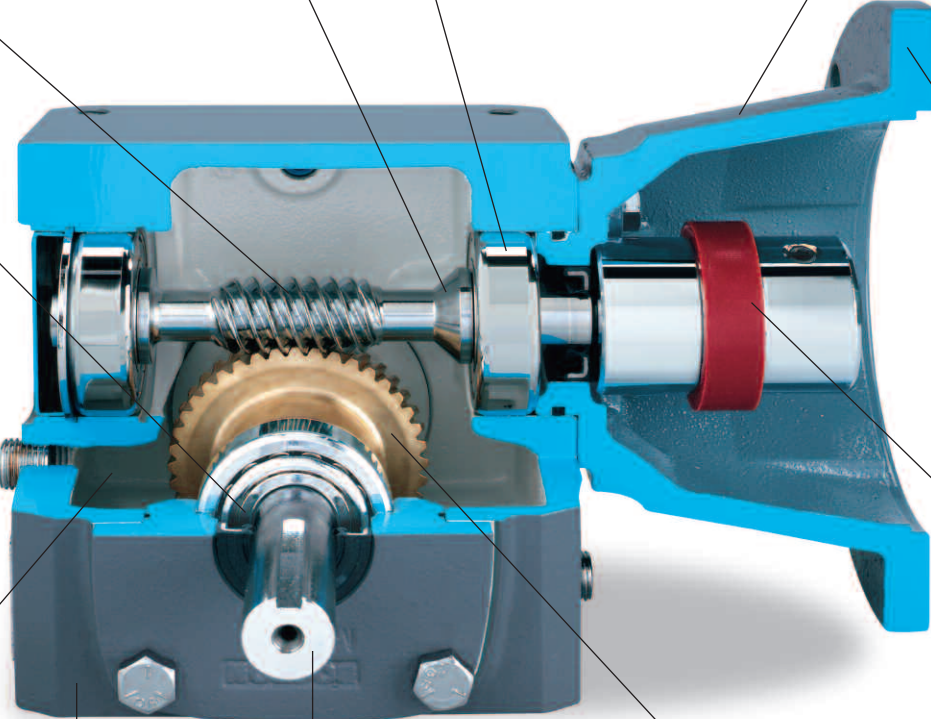
- 
- Super-finished oil seal diameters on both input and output shafts provide extended seal life.
 - High pressure angle on worm provides greater operating efficiency.
 - Integral input worm and shaft design made from high-strength case-hardened alloy steel. Reducer sizes 710 through 730 have pre-lubricant ball bearings; 732 through 760 have tapered roller bearings. Double lip oil seals are standard.
 - Double bearing input design on all QC 700 sizes along with optional double seals.
 - The elimination of the coupling alignment hole ensures that debris and bacteria will not collect on this reducer.
 - This smooth, BISSC® approved clean motor flange dramatically improves any washdown application.
 - Unique patent pending coupling design eliminates fretting corrosion and allows for blind assembly of NEMA motors.
 - High-strength steel output shaft assures capacity for high torque and overhung loads.
 - High-strength bronze worm gear is straddle mounted between heavy-duty tapered roller bearings to increase thrust and overhung load capacities, sizes 713-760.
 - Large oil reservoir provides highly efficient heat dissipation and lubrication for longer operating life.
 - PosiVent® option is lubed-for-life, virtually maintenance-free.
 - Rugged housing of fine-grained, gear-quality cast iron provides maximum strength and durability. Greater rigidity and one-piece construction ensure precise alignment of the worm and gear. This housing construction also provides superior resistance to caustic washdown solutions, plus high heat dissipation and reduced noise level. Pipe plugs allow easy fill, level and drain in any mounting position.

Dimensions

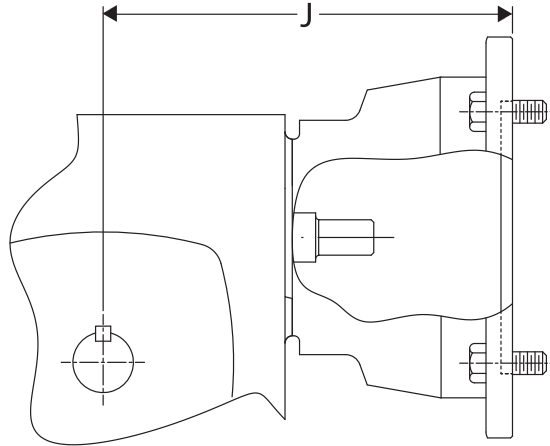

QC Compared To RF					Design Space Savings
CD/Reduction		NEMA	J-NEMA Mounting		
Single	Double		QC	RF	
710	W713	42CZ	4.15	4.76	0.61
	W718	56C	5.01	5.72	0.71
713	W721	56C	5.46	6.59	1.13
	W726				
715		56C	6.11	7.34	1.23
		140TC			
718	W730	56C	6.29	7.53	1.24
	W732	140TC			
721	W738	56C	6.76	8.31	1.55
		140TC			
724		56TC	6.95	8.50	1.55
		140TC			
		180TC			
726	W752	56TC	7.39	9.47	2.08
		140TC			
		180TC			
730		56TC	7.84	9.92	2.08
		140TC			
		180TC			
732	W760	56TC	8.20	10.28	2.08
		140TC			
		180TC			
738		140TC	8.70	11.81	3.11
		180TC			
		210TC			

Dimensions in inches

700 Series Single Reduction Catalog Number Explanation

HQC 7 32 R - 30 Z F P - B7 H 3 - P20

700 SERIES

STYLE

Blank - Projecting I/P & O/P shafts (No flange)

H - Projecting I/P, BostMount hollow O/P shaft, (No flange)

S - Projecting I/P, hollow O/P shaft (No flange)

F - Flanged reducer (Quill type), projecting O/P shaft

HF - Flanged reducer (Quill type), BostMount hollow O/P shaft

SF - Flanged reducer (Quill type), hollow O/P shaft

QC - Flanged reducer (Coupling type), projecting O/P shaft

HQC - Flanged reducer (Coupling type), BostMount hollow O/P shaft

RF - Flanged reducer (Coupling type), Projecting O/P shaft, 752-760 sizes only

SSF* - Stainless flanged reducer (Quill type) projecting O/P shaft

SSHF* - Stainless flanged reducer (Quill type) BostMount hollow O/P shaft

C Prefix - Cast iron flange and base (* SSF/SSHF sizes 718, 721, 726 only)

CENTER DISTANCE
(inches)

10 - 1.00
13 - 1.33
15 - 1.54
18 - 1.75
21 - 2.06
24 - 2.38
26 - 2.62
30 - 3.00
32 - 3.25
38 - 3.75
52 - 5.16
60 - 6.00

REDUCTION RATIO TO 1

5
10
15
20
30
40
50
60

FAN
(732-760 sizes only)

Blank - No fan
F - Fan kit
E - End cap available 732 & 738 only, when no fan is used.

P-Pressure Relief

H SERIES OUTPUT BORE CODE
For H700 Series only. Specified in 1/16" increments. See Worm Gear Drives Catalog for complete offering. Example: 1 1/4" = P20

LUBRICATION

Z - Posivent® (factory filled with Klubersynth UH1 6-460)

Blank - No Lube
K - Klubersynth UH1 6-460

BASE

Blank - No base kit required

A - Horizontal base - Worm under
B - Horizontal base - Worm over
C - Vertical High base - I/P right
D - Vertical Low base - I/P right
E - Vertical High base - I/P left
F - Vertical Low base - I/P left

R/L - BostMount Output Bracket
X - Input Vertical Up
Y - Input Vertical Down
V - Hollow O/P with base - I/P left
W - Hollow O/P with base - I/P right
M - Hollow O/P with CFA - I/P left
N - Hollow O/P with CFA - I/P right

NEMA MOUNTING

BORE CODE	NEMA MOUNTING	INPUT BORE	KEYWAY
B4	42CZ	.500"	1/8 x 1/16
B5	56C	.625	3/16 x 3/32
B7	140TC/180C	.875	3/16 x 3/32
B9	180TC/210C	1.125	1/4 x 1/8
B11	210TC/250UC	1.375	5/16 x 5/32
B13	250TC	1.625	3/8 x 3/16

MOUNTING POSITIONS

Blank - No Lubrication Supplied

For Factory Prelubrication Indicate Mounting Position

1 - Standard Mounting
2-6 - Refer to Mounting Positions in Catalog

OUTPUT SHAFT ASSEMBLY
(When facing Input)

G* - O/P Projection - Left
H* - Double O/P Projection
J* - O/P Projection - Right

* Add "S" after letter for Stainless Steel Shaft (ex. GS, HS, JS)

700 Series Double Reduction Catalog Number Explanation

HQCWA 7 26 B- 100 Z F P - B5 - H 3 - P20

700 SERIES

STYLE

WA - Parallel shafts, projecting I/P & O/P

HWA - Parallel shafts, projecting I/P, BostMount Hollow O/P

SWA - Parallel shafts, projecting I/P, hollow O/P

WC - Right Angle shafts, projecting I/P & O/P

HWC - Right Angle shafts, projecting input, BostMount hollow output shaft

SWC - Right Angle shafts, projecting I/P, hollow O/P

FWA - Parallel shafts, Quill type I/P, projecting O/P

HFWA - Parallel shafts, Quill type I/P, BostMount Hollow O/P

SFWA - Parallel shafts, Quill type I/P, hollow O/P

FWC - Right Angle shafts Quill type I/P, projecting O/P

HFWC - Right Angle shafts, Quill type input, BostMount hollow output shaft

SFWC - Right Angle shafts, Quill type I/P hollow O/P

QCWA - Parallel shafts, Coupling type I/P, projecting O/P

HQCWA - Parallel shafts, Coupling type I/P, BostMount hollow O/P

QCWC - Right Angle shafts, Coupling type I/P, projecting O/P

HQCWC - Right Angle shafts, Coupling type input, BostMount hollow output shaft

C Prefix - Cast iron flange and base

CENTER DISTANCE
(inches)

13 - 1.33
18 - 1.75
21 - 2.06
26 - 2.62
30 - 3.00
32 - 3.25
38 - 3.75
52 - 5.16
60 - 6.00

REDUCTION RATIO TO 1

100 1200
150 1800
200 2000
300 2400
400 3000
600 3600
900

FAN
(732-760 sizes only)

Blank - No fan
F - Fan kit
E - End cap available 732 & 738 only, when no fan is used.

P-Pressure Relief

H SERIES OUTPUT BORE CODE*
For H700 Series only. Specified in 1/16" increments. See Worm Gear Drives Catalog for complete offering. Example: 1 1/4" = P20

*H Series Only

BASE

Blank - No base kit required

A & B - Horizontal bases
C & E - Vertical High bases
D & F - Vertical Low bases

R/L - BostMount Output Bracket
X - Input Vertical Up
Y - Input Vertical Down
V/W - Hollow O/P with base
M/N - Hollow O/P with CFA

NEMA MOUNTING

BORE CODE	NEMA MOUNTING	INPUT BORE	KEYWAY
B4	42CZ	.500"	1/8 x 1/16
B5	56C	.625	3/16 x 3/32
B7	140TC/180C	.875	3/16 x 3/32
B9	180TC/210C	1.125	1/4 x 1/8

LUBRICATION

Z - Posivent® (factory filled with Klubersynth UH1 6-460)

Blank - No Lube
K - Klubersynth UH1 6-460

MOUNTING POSITIONS

Blank - No Lubrication Supplied

For Factory Prelubrication Indicate Mounting Position

1 - Standard Mounting
2-6 - Refer to Mounting Positions in Catalog

OUTPUT SHAFT ASSEMBLY
(When facing Input)

G* - O/P Projection - Left
H* - Double O/P Projection
J* - O/P Projection - Right

* Add "S" after letter for Stainless Steel Shaft (ex. GS, HS, JS)



www.bostongear.com

701 Carrier Drive
Charlotte, NC 28216 - USA
704-588-5610
Fax: 704-588-7181

P-1479-BG 10/09 Printed in USA